

**Revell**  
*Authentic Kit*

ASSEMBLY INSTRUCTIONS FOR YOUR

# MARTIN LACROSSE MOBILE LAUNCHER

KIT 1816

SCALE: 1" = 3'4"

## HISTORY OF YOUR MARTIN LACROSSE

The Army's newest surface-to-surface guided missile, LACROSSE, is controlled from a forward observation station in order to enable it to hit its target without having a complicated computer installation at its launching site. When a target is located by the forward station the missile is fired from the launching site and directed into the target by the light and mobile forward guidance station.

Although LACROSSE was originally designed for close troop support, its role has been expanded to include general military support, and the missile is capable of delivering numerous types of warheads. The units are self-contained and highly mobile, having a simple and efficient supporting system. All units are vehicle mounted, and can be air-lifted to battle areas when necessary. Because of this mobility, it presents a difficult target for the enemy. A standard ARMY 2½ ton

6 x 6 truck chassis serves as a launcher.

LACROSSE has an overall length of 19.2 feet, a fuselage diameter of 20.5 inches, a wingspan of 9 feet, and a fin span of 4.7 feet. The missile body has three major assemblies, the nose section or warhead, the center section, which includes the guidance equipment, and the tail section with its solid propellant rocket engine. Four swept wings and four movable tail fins control pitch, yaw, and roll, keeping the rocket on course, and fit quickly into recesses in the fuselage. The missile has a range of between 15 and 20 miles.

The MARTIN COMPANY is one of the pioneers in the American missile program, having developed the VIKING, the MATADOR and the VANGUARD. The LACROSSE represents an important trend in the development of modern artillery weapons.

# IMPORTANT!

READ  
THIS  
FIRST:



1. NOTE: *Do not let cement touch your eyes or clothing.* This kit is molded of Styrene Plastic. Use only
2. Apply cement to *only* those surfaces where parts join. Use sparingly, since any excess cement may run and damage the details on your model.
3. Locate and identify all parts for each step before you begin that step. All parts are numbered, or the numbers are engraved on the bar next to each part, so that each part can be located easily. IMPORTANT: DO NOT BREAK ANY PART FROM ITS BAR UNTIL IT IS TO BE USED.

4. For the best fit, carefully trim any excess plastic from parts before assembling.
5. If you wish, paint all parts where indicated and allow them to dry before assembling.
6. The directions for applying Decals are on the back of the Decal Sheet. Use a small brush to wet your model and help place the Decals into position.
7. NOW CAREFULLY FOLLOW THESE NUMBERED STEPS FOR EASE IN BUILDING YOUR MODEL.

1

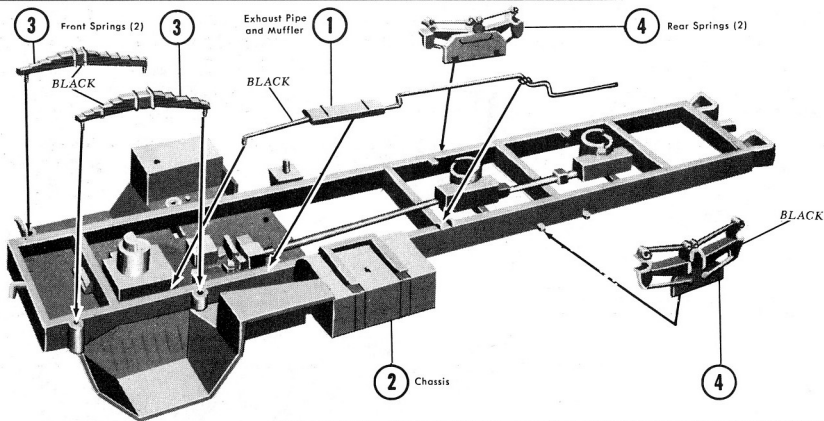

## PAINT THE DETAILS, AS SHOWN, BEFORE ASSEMBLING.

- A. Cement **Part 1** into place on **Part 2**, as shown. NOTE: Locate Muffler on top of the frame edge.
- B. Cement **Parts 3** onto **Part 2**.
- C. Cement **Parts 4** onto **Part 2**. Allow cement to dry.

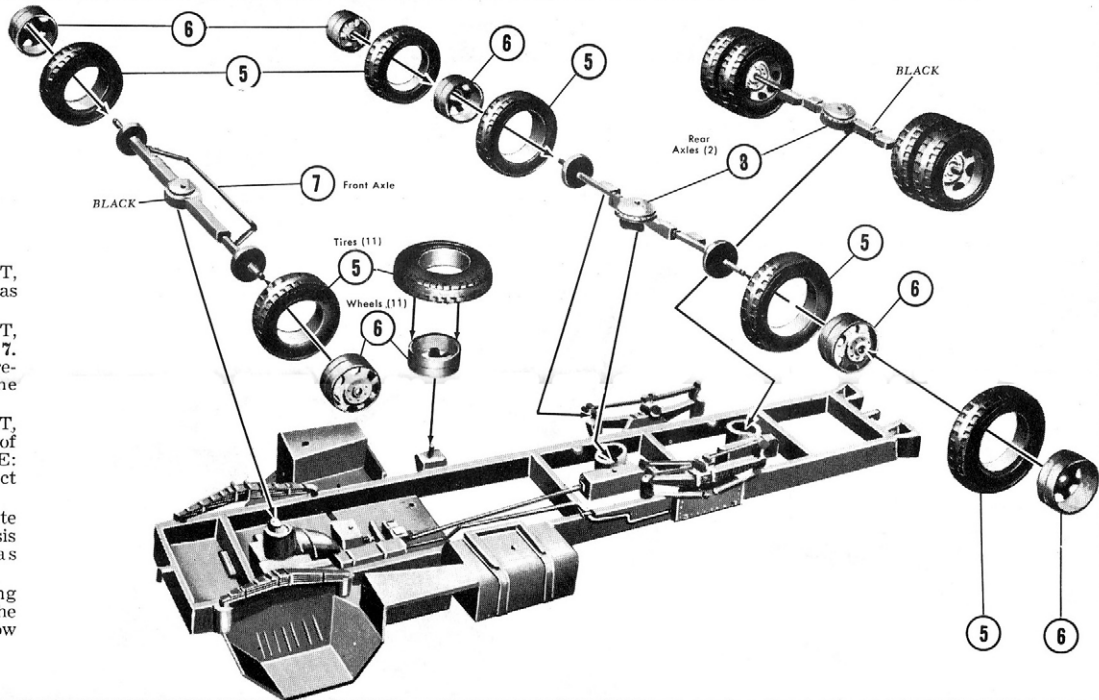

**PAINT THE DETAILS,  
AS SHOWN, BEFORE  
ASSEMBLING.**

- A.** Snap, **DO NOT CEMENT**, **Parts 5** onto **Parts 6**, as shown.
- B.** Snap, **DO NOT CEMENT**, two **Parts 6** onto **Part 7**. Then cement **Part 7** carefully into place on the Chassis.
- C.** Snap, **DO NOT CEMENT**, four **Parts 6** onto each of the two **Parts 8**. **NOTE:** See Drawing for correct position of Wheels.
- D.** Apply cement and locate **Parts 8** onto the Chassis and Rear Springs, as shown.
- E.** Cement the remaining **Part 6** into place on the Chassis, as shown. Allow to dry completely.

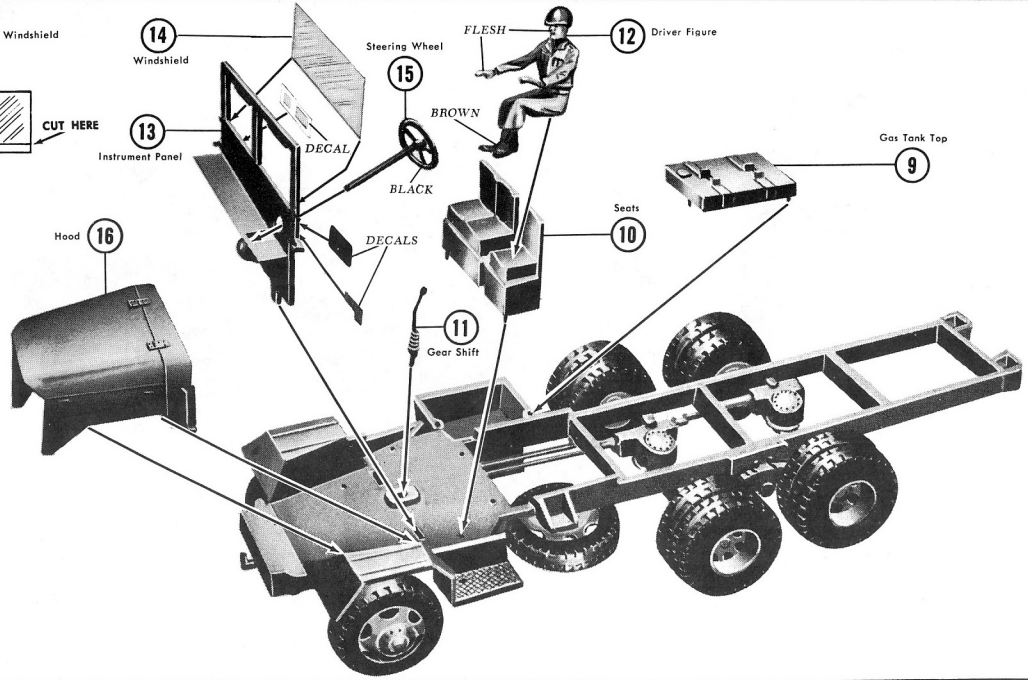
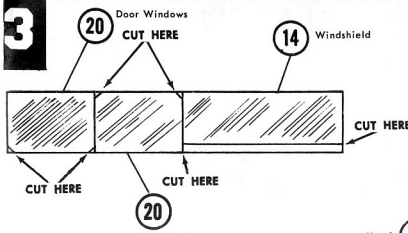

**PAINT THE DETAILS,  
AS SHOWN, BEFORE  
ASSEMBLING.**

- A. Turn Chassis right side up.
- B. Cement **Part 9** into place on the Chassis, as shown.
- C. Cement **Parts 10 and 11** onto the Chassis, as shown.
- D. Cement **Part 12** onto the *smaller seat* of **Part 10**.
- E. Apply Decals to **Part 13**, as shown, and allow to dry. Cement **Parts 14 and 15** into place on **Part 13**. Then cement **Part 13** onto the Chassis.
- F. Cement **Part 16** onto the Chassis, as shown.

## PARTS LIST FOR YOUR LACROSSE

1. Exhaust Pipe and Muffler	19. Cab Roof	37. Hydraulic Box Guard	55. Piston Rod
2. Chassis	20. Door Windows	38. Front Control Box Half	56. Hydraulic Line
3. Front Springs (2)	21R. Right Door	39. Rear Control Box Half	57. Hydraulic Cylinder Cap
4. Rear Springs (2)	22L. Left Door	40. Control Box Instrument Panel	58. Hydraulic Cylinder
5. Tires (11)	23R. Right Mirror	41. Control Panel Door	59. Launcher Arm Base
6. Wheels (11)	24L. Left Mirror	42. Forward Platform	60. Hydraulic Pump
7. Front Axle	25. Headlights (2)	43R. Right Center Platform	61. Fins
8. Rear Axles (2)	26. Jerry Can	44L. Left Center Platform	62. Fuselage Half
9. Gas Tank Top	27. Cable Reel	45R. Right Rear Platform	63. Fuselage Half with Fins
10. Seats	28. Launcher Bed	46L. Left Rear Platform	64. Vertical Tail Fins
11. Gear Shift	29. Hydraulic Unit Box	47. Ladders (2)	65. Tail Cap
12. Driver Figure	30. Access Door	48. Side Rails (2)	66. Horizontal Tail Fins
13. Instrument Panel	31R. Right Side Panel	49. Tail Plate Levers	67. Nose Cone
14. Windshield	32L. Left Side Panel	50. "Explosive" Sign	68. Kneeling Figure
15. Steering Wheel	33. Tool Box Door	51R. Launcher Arm Right Half	69. Standing Figure
16. Hood	34. Front Forward Platform Frame	52L. Launcher Arm Left Half	70. Figure Bases (2)
17. Radiator Grille	35. Rear Forward Platform Frame	53. Missile Track	71. Decals
18. Cab Back Wall	36. Tail Plate	54. Launcher Control Unit	

CUT HERE

4

### PAINT THE DETAILS, AS SHOWN, BEFORE ASSEMBLING.

- A.** Cement **Part 17** onto the Chassis and Hood.
- B.** Cement **Part 18** onto the Chassis and Seats.
- C.** Cement **Part 19** into place as shown.
- D.** Carefully cement **Parts 20** onto **Parts 21R** and **22L**. Then, as shown in Small Drawing "A", insert the bottom pin on **Parts 21R** and **22L** into the holes in the right and left sides of the Hood and hook the top pin on these parts onto the *locating brackets*. The Doors will now open and close easily.
- E.** Cement **Parts 23R** and **24L** into place, as shown.
- F.** Cement **Parts 25** and **Part 26** into place on Chassis.

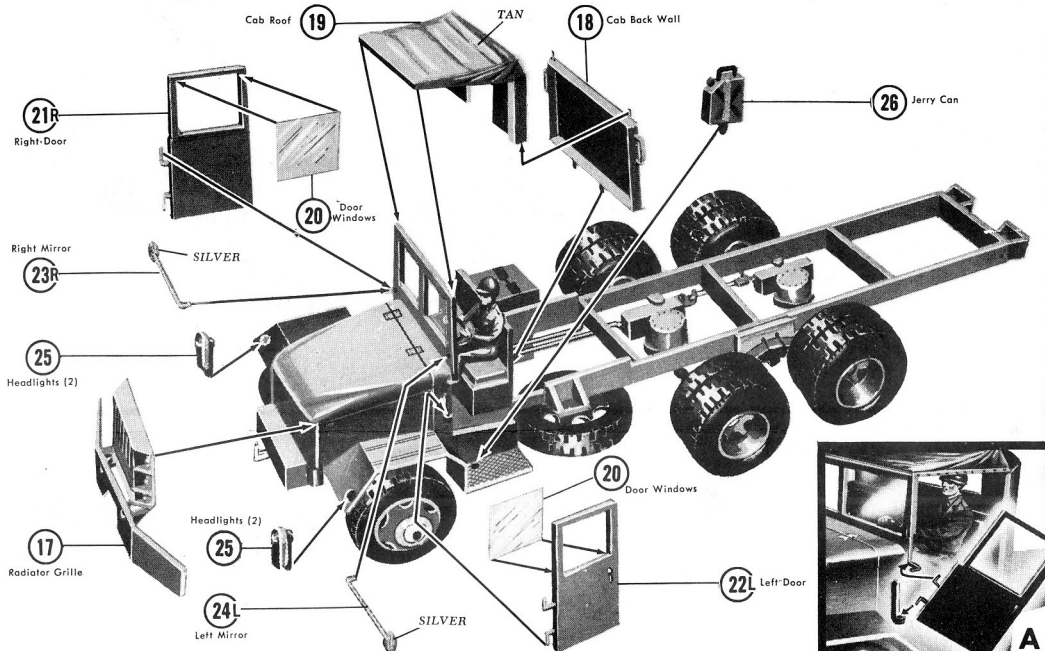

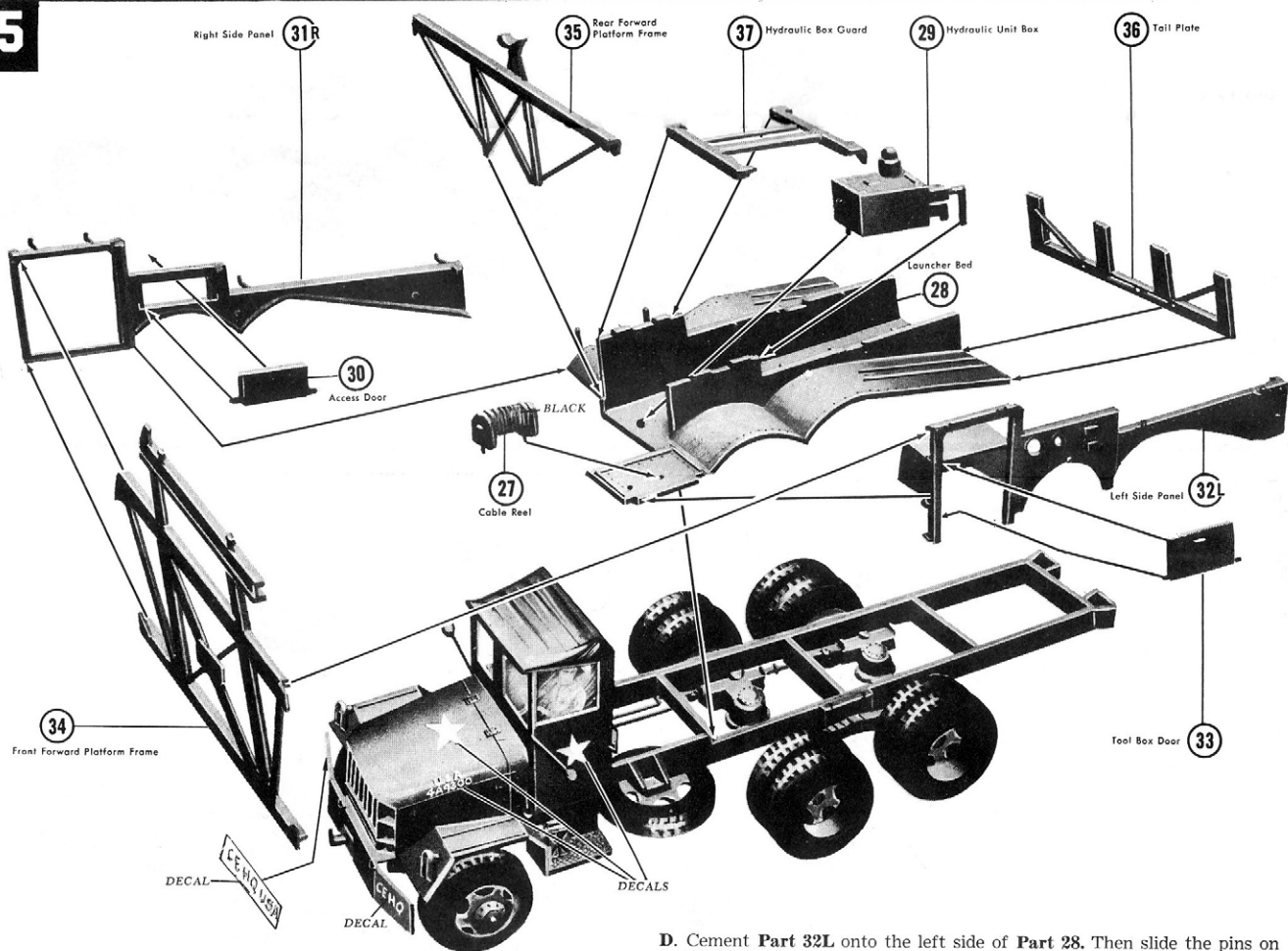

**PAINT THE DETAILS, AS SHOWN, BEFORE ASSEMBLING.**

**A.** Cement Part 27 onto Part 28.

**B.** Cement Part 29 onto Part 28.

**C.** Locate, DO NOT CEMENT, the pins on Part 30 into the slots in Part 31R so that Part 30 opens outward. Then carefully cement Part 31R onto the right side of Part 28, as shown. NOTE: No cement should touch Part 30 or it will not open easily.

**D.** Cement Part 32L onto the left side of Part 28. Then slide the pins on Part 33 upward from under the tool box opening until those pins snap into place between Parts 28 and 32L.

**E.** Cement Part 34 onto Parts 31R and 32L, as shown.

**F.** Cement Part 35 onto Parts 28, 31R, and 32L, as shown.

**G.** Cement Part 36 onto Parts 28, 31R, and 32L, as shown.

**H.** Cement Part 37 into place on Part 28.

**I.** Apply cement and carefully locate the Launching Unit onto the Truck Chassis, as shown. Apply Decals, as shown, and set aside to dry.

**PAINT THE DETAILS, AS SHOWN, BEFORE ASSEMBLING.**

- A.** Cement **Parts 38** and **39** together. Apply Decal to **Part 40**, allow to dry, and then cement **Part 40** into **Parts 38** and **39**, as shown.
- B.** Hold **Part 41** at an angle between **Parts 38** and **39**, and carefully twist **Part 41** until its pins snap into the holes in **Parts 38** and **39**.
- C.** Cement **Parts 42, 43R, 44L, 45R,** and **46L** into place on Launching Unit, as shown.
- D.** Slide, **DO NOT CEMENT, Parts 47** down through the *hangers* on **Parts 45R** and **46L**, as shown. These Ladders can then be displayed in an upright position or resting on the Platforms.
- E.** Locate, **DO NOT CEMENT, Parts 48** into the holes in the platforms, as shown. These parts may be removed and hung onto the hooks on the side of the truck when displaying Missile in *launching position*.
- F.** Cement **Parts 49** and **50** into place on the Tail Plate.
- G.** Apply Decals, as shown, and set aside to dry.

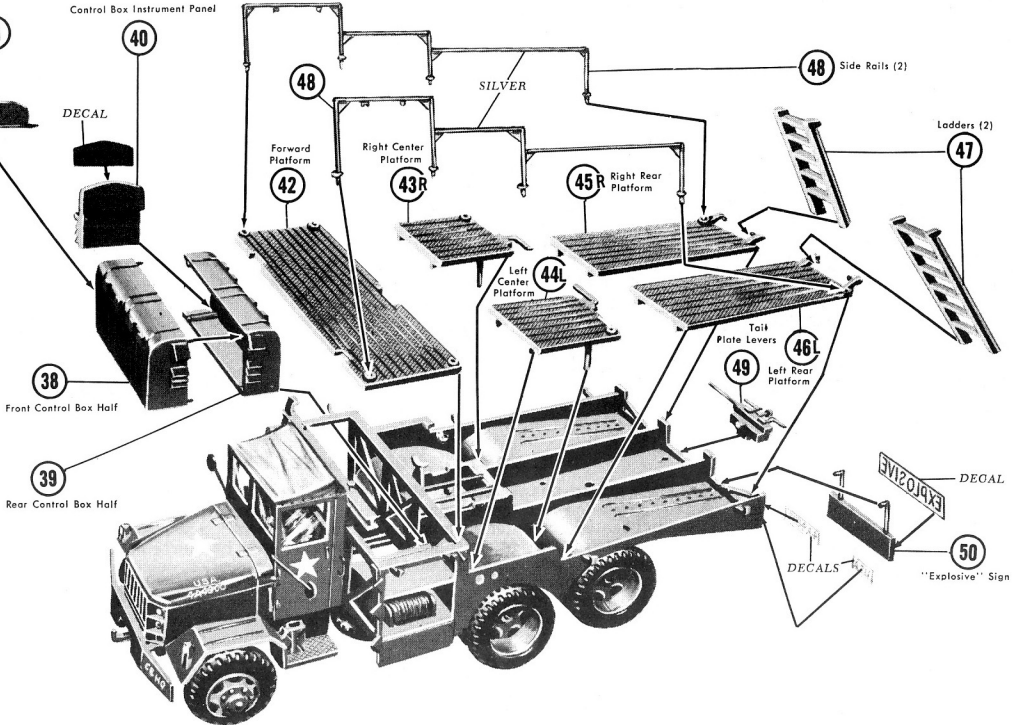

Control Box Instrument Panel

Control Panel Door

DECAL

SILVER

Side Rails (2)

Ladders (2)

Forward Platform

Right Center Platform

Right Rear Platform

Left Center Platform

Tail Plate Levers

Left Rear Platform

Front Control Box Half

Rear Control Box Half

DECAL

DECALS

"Explosive" Sign

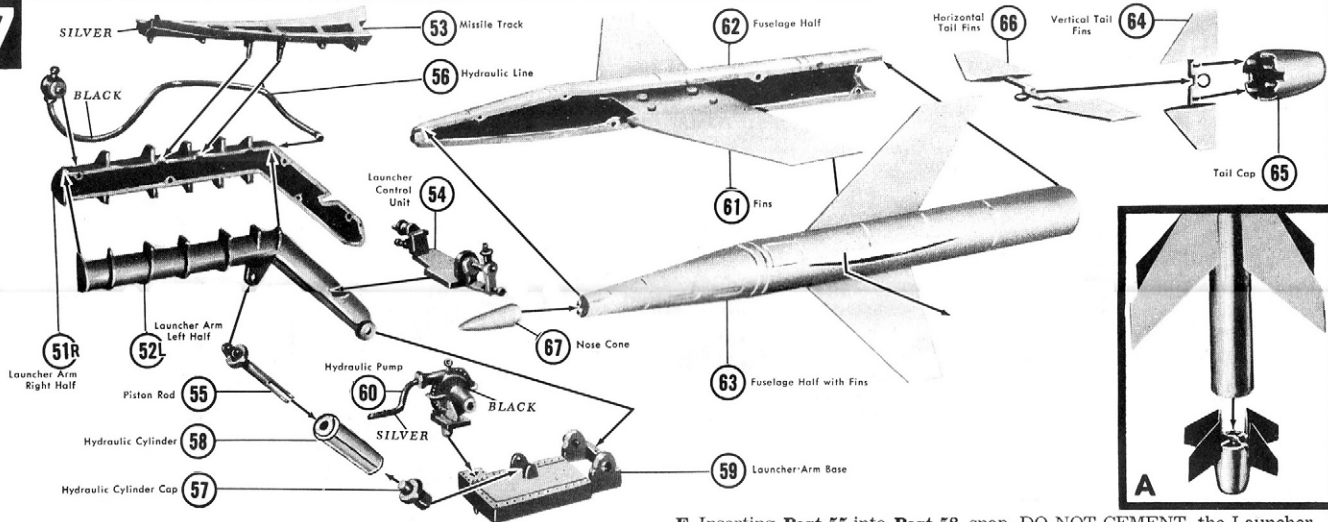

**PAINT THE DETAILS, AS SHOWN, BEFORE ASSEMBLING.**

**A.** Cement **Parts 51R** and **52L** together. Then cement **Parts 53** and **54** onto the Launcher Arm.

**B.** Snap, DO NOT CEMENT, **Part 55** onto the Launcher Arm. Then cement **Part 56** into place, as shown.

**C.** Cement **Part 57** onto **Part 58**. Then snap, DO NOT CEMENT, **Part 57** into place on **Part 59**.

**D.** Cement **Part 60** onto **Part 59**.

**E.** Inserting **Part 55** into **Part 58**, snap, DO NOT CEMENT, the Launcher Arm into place on **Part 59**, as shown. Set aside to dry.

**F.** Locate, DO NOT CEMENT, **Part 61** through the slot in **Part 62**, as shown. Then, locating **Part 61** through **Part 63**, cement **Parts 62** and **63** together.

**G.** Locate, DO NOT CEMENT, **Part 64** onto **Part 65**. Then locate, DO NOT CEMENT, **Part 66** onto **Parts 64** and **65**.

**H.** Carefully cement the Missile Fuselage onto **Part 65**. NOTE: No cement should touch **Parts 64** and **66** or they will not move freely. See small Drawing "A". Cement **Part 67** onto the Missile Fuselage.



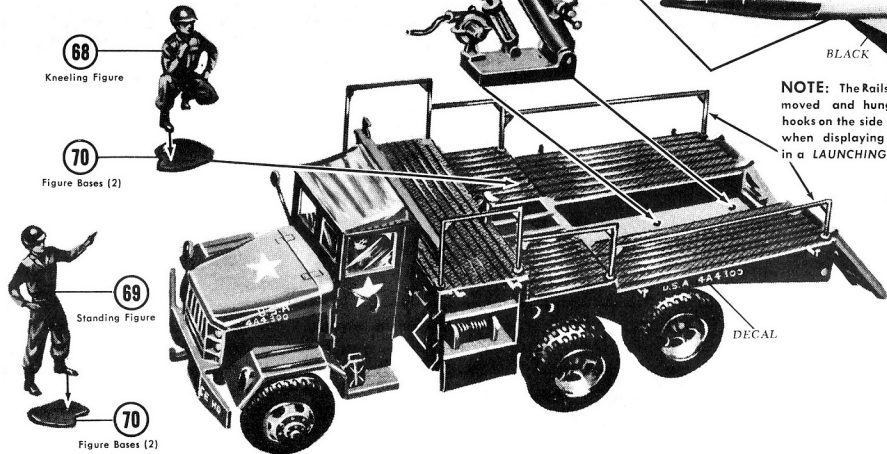

**NOTE:** The Rails can be removed and hung onto the hooks on the side of the truck when displaying the Missile in a LAUNCHING POSITION.

**PAINT THE DETAILS, AS SHOWN, BEFORE ASSEMBLING.**

- A. Apply Decals, as shown, and allow to dry *completely*.
- B. Cement the Launcher Arm Unit into place on the Launching Unit.
- C. Place, **DO NOT CEMENT**, the Missile onto the Launcher Arm Unit, as shown, if you wish the Missile to be removable. Otherwise, cement the Missile into place.
- D. Finally, cement **Parts 68** and **69** onto **Parts 70**. These may be displayed beside your model as shown, or any way you wish.

**Revell**  
Authentic Kits

# Fun to build...Fun to collect and display!

## MISSILES AND ROCKETS by Revell

Over a dozen authentic rocket-age hobby kits—start building your collection now!



**3-Stage Rocket to the Moon!**  
H-1800 XSL-01 Manned Space Ship



**Long-Range Defender!**  
H-1806 Bomarc I.M.

**More Revell Missiles**  
H-1808 Talos  
H-1810 X-17  
H-1812 Tactical Missiles Set  
H-1814 Aerobee-HI



**Intercontinental Missile!**  
H-1801 Snark S-M-62



**Large-Scale Fighter!**  
H-256 Spad

## REVELL PLANES

Revell offers the widest variety of model airplanes for a complete collection!



**Historic German Triplane!**  
H-270 Fokker DR-1 Triplane



**Large-Scale Fighter!**  
H-256 Spad



**Airborne Refueling!**  
H-287 KC-135 Jet Tanker



**Radar Patrol Plane!**  
H-279 Lockheed WV-2  
Radar Picket Plane



**Colorful Seaplane!**  
H-258 Martin Mariner PBM-5

**America's Fastest Bomber!**  
H-252 Convair B-58 Hustler



## STARBURST MOBILE

Plane Display  
• holds 14 planes!  
• hangs from the ceiling!  
• stands on a table!  
• 22" diameter!

## REVELL SHIPS

The world's largest collection of model ships for you to choose from.



**H-353 U.S.S. Essex**  
20" carrier model has movable elevators and cranes, 27 planes, plus tractor, truck, 17 steel antennas.

Have you built these other Revell ships?

- H-348 Battleship U.S.S. Arizona
- H-352 Destroyer U.S.S. Forrest Sherman
- H-355 Destroyer Escort U.S.S. Buckley
- H-346 Moore-McCormack S.S. Brasil

## REVELL COMBAT MODELS

Authentic U.S. Army models scaled to work together in battle layouts.



**H-522 M-4 Sherman Tank**  
Exciting action kit has movable wheels and tracks, movable machine guns, 6-man crew, 7¼"

### More Revell Combat Models

- H-536 18 Ton High Speed Tractor
- H-538 Russian T-34 Tank
- H-535 M-2 155mm Field Artillery Piece

## REVELL SAILING SHIPS

Spectacular models anyone can assemble and display with master shipbuilder's pride!



**H-347 U.S. Coast Guard Cutter Eagle**  
Molded in 3 colors, this 13¾" replica of the famous cadet training ship has 19 contoured plastic sails, movable yards, fine detail.

### Other Revell Sailing Ships:

- H-327 H.M.S. Bounty
- H-336 Santa Maria
- H-344 Flying Cloud

## REVELL AUTOMOTIVE LEADERS

A terrific collection of fabulous experimental show-cars and famous Detroit production cars!



**H-1214 Cadillac Brougham**  
New larger scale model has clear plastic windshields, metallized chrome parts, two figures.

### Some Famous Revell Car Kits

- H-1209 Continental Mark II
- H-1210 Lincoln Futura
- H-1213 Pontiac Club de Mer
- H-1220 Ford Country Squire

**Revell**  
H-O electric trains

# For more fun with an electric train—GO REVELL H-O!

## READY-TO-RUN TRAIN SETS



SET #1



SET #2



SET #3

**SET NO. 1: F7 ROAD DIESEL AND 3 CARS**—8 wheel gear drive, working headlight and track, choice of New Haven or Union Pacific colors and markings.

**SET NO. 2: SW7 DIESEL SWITCHER AND 3 CARS**—Worm gear drive, working headlight, "lift up" load, track, choice of New Haven or Union Pacific lines.

**SET NO. 3: UNION PACIFIC 0-6-0 STEAM LOCO AND 3 CARS**—Real smoke, real chug-a-chug, real operating pistons, working headlamp, track.

## REVELL H-O ROLLING STOCK

12 authentic freight cars... 18 famous railroad lines to choose from!



Pickle Car



Cable Reel Car

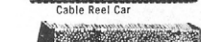

Pulpwood Car



## REVELL H-O TOWN & COUNTRY ACCESSORIES

Make Your Model Railroad Come Alive!



**TRACKSIDE BUILDINGS**  
Unbelievably detailed—molded in 3 colors—snap-together set includes 2-story tower, switchman's shanty, tender's shack, water tower, water spout, six figures.



**COMPLETE FARMHOUSE SET**  
Perfect replicas of a farmhouse, garage, chicken coop and outhouse all snap together without cement. Real-life figures and animals included in the set.

### OPERATING CROSSING GATE

Realistic, fully automatic unit snaps right onto your track—needs no wires. Complete crossing scene includes flashing lights, automatic gate, road, track, realistic terrain.

**U.S. ARMY  
U.S. ARMY**

MISSILE

U.S.A. 4A4300

U.S.A. 4A4300

CHASSIS SIDES

U.S.A. 4A4300

CHASSIS REAR

DASH



U.S.A. CE HQ U.S.A.

FRONT BUMPER

**EXPLOSIVE**

SIGN



COMPRESSOR



DASH

HOOD



HOOD  
SIDES

U.S.A.  
4A4300

U.S.A.  
4A4300

**85181600300 LA CROSSE MISSILE  
©REVELL-MONOGRAM. ALL RIGHTS RESERVED.**